

# INSTALLATION TYPES

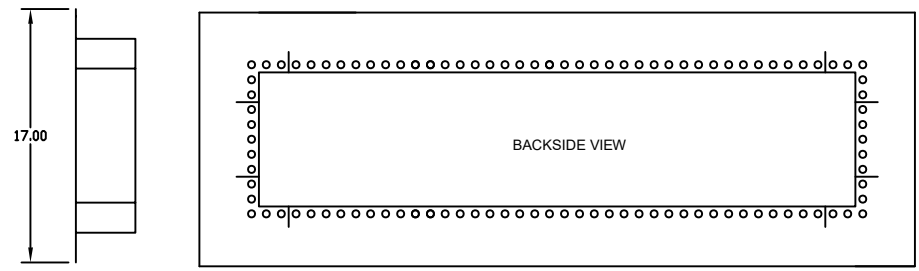
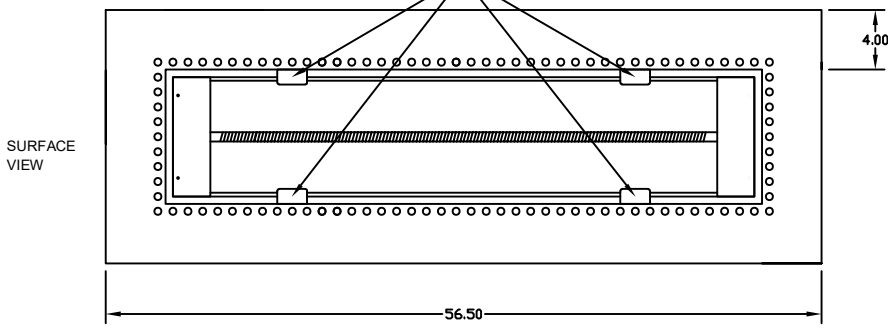
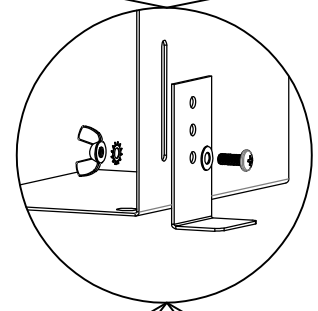
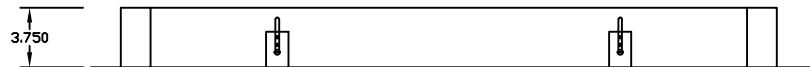
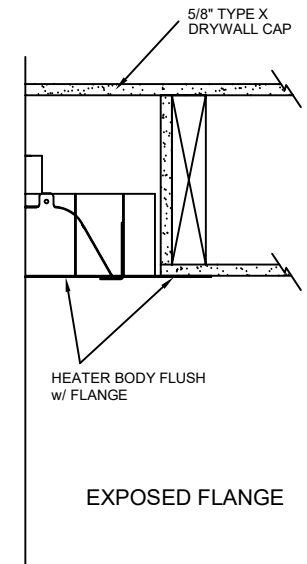
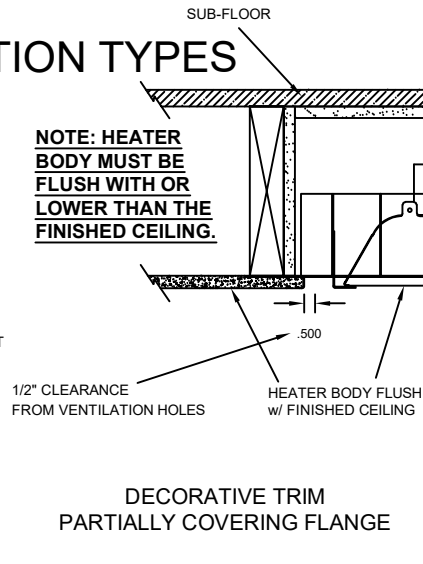
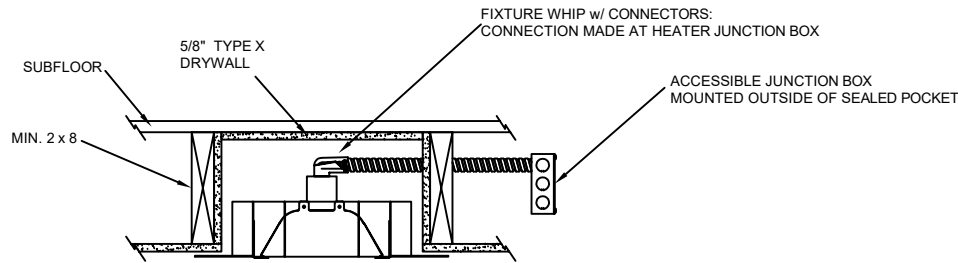
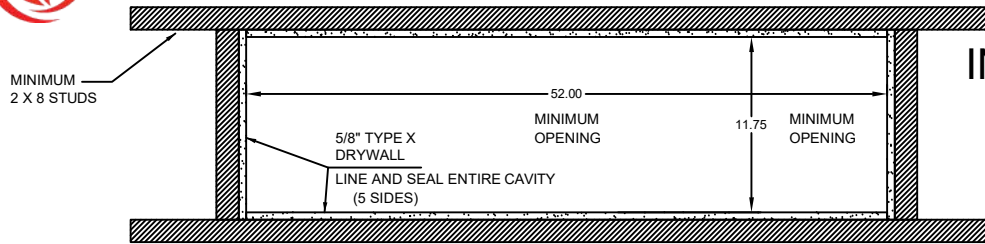

- WARNINGS:**
- Do not use Surface Mount Brackets.
  - This Frame is **ONLY** to be used on a flat non-sloped ceiling.
  - Heater Body must face straight down and be flush with the finished ceiling.
  - Frame and Heater cannot be installed on a pitched angle.
  - Accessible Junction Box must be installed outside of sealed drywall pocket.
  - Must use 5/8" type "X" drywall.
  - Must use supplied 4 foot Hi-Temp Fixture Whip and Hi-Temp Ceramic Wire Nuts.
  - Please contact factory for longer length Hi-Temp Fixture Whips available for purchase.
  - Discard Surface Mounting Brackets provided with Heater and use "L" Brackets.
  - Use Licensed Electrician ONLY.

- NOTES:**
- Heater suspends (Gravity) by resting on adjustable "L" Brackets in flush mount fixture.
  - Mounting holes on Surface Flange to be determined and drilled by Contractor/Installer.
  - Coil excess flex into heater cavity.

*After 4 hours of continuous use, a 15 minute cool down period is recommended for maximum heater longevity. See controls brochure for timer options.*

<b>INFRATECH™</b>		
ITEM #:	18-2302	MATERIAL:
		304 S.S. #4 FINISH
DESCRIPTION:		
48" FLUSH MOUNT TRIM KIT		
NOTES:		
SUPPLIED w/ HI-TEMP FIXTURE WHIP		
DATE:	SCALE:	DRAWN BY:
Aug. 1, 2024	N/A	MD